

## Countersunk Steel Reduced Head - Semi-Hex Shank - Open Type

## Description

## Reduced Head Countersunk HEX

Ideal for applications that require an open nut insert and an almost flush head finished with high torque-to-turn ratio.

## Specifications

|                     |             |
|---------------------|-------------|
| <b>Material</b>     | Steel       |
| <b>Finish Clear</b> | Zinc Plated |

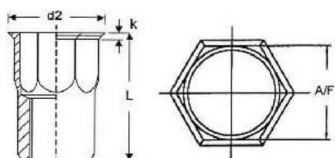

| Part Number  | Thread Size | Grip Range | Hex Hole | Hex Size d2 +0.3 | L +0.5 | A/F 0.15 |
|--------------|-------------|------------|----------|------------------|--------|----------|
| INSERTEX M4  | M4 x 0.7    | 0.5-2.5    | 6.4      | 7                | 11     | 6.3      |
| INSERTEX M5  | M5 x 0.8    | 0.5-3.0    | 7.3      | 8                | 12     | 7.1      |
| INSERTEX M6  | M6 x 1.0    | 0.5-3.0    | 9.7      | 10               | 14     | 9.5      |
| INSERTEX M8  | M8 x 1.25   | 0.5-3.0    | 10.7     | 12               | 16     | 10.5     |
| INSERTEX M10 | M10 x 1.50  | 0.5-3.5    | 13.0     | 14.2             | 18.3   | 12.8     |

| Thread Size | Pull-Out KN | Push-Out KN | Torque-To-Turn Nm | Maximum Torque |
|-------------|-------------|-------------|-------------------|----------------|
| M5 x 0.8    | 5.8         | 2.5         | 7.4               | 7.8            |
| M6 x 1.0    | 8.7         | 2.9         | 10.3              | 12.3           |
| M8 x 1.25   | 9.9         | 3.7         | 22.1              | 31.4           |

## Open End Steel Large Flange - Semi Hex Shank

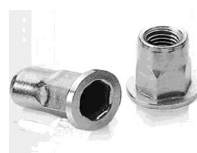
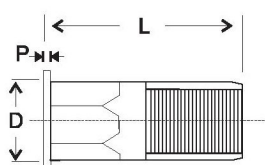

| Part Number    | Thread Size | Grip Range (mm) | Hole Size Across Flat +0.1 - 0.00 | D  | P =0.12 | A =0.08 | L    |
|----------------|-------------|-----------------|-----------------------------------|----|---------|---------|------|
| INSERTEX M4LF  | M4          | 0.5-2.0         | 6                                 | 9  | 1.0     | 5.89    | 10.0 |
| INSERTEX M5LF  | M5          | 0.5-3.0         | 7                                 | 10 | 1.0     | 6.89    | 13.2 |
| INERTSEX M6LF  | M6          | 0.5-3.0         | 9                                 | 13 | 1.5     | 8.89    | 15.5 |
| INSERTEX M8LF  | M8          | 0.5-3.0         | 11                                | 16 | 1.5     | 10.89   | 18.0 |
| INSERTEX M10LF | M10         | 1.0-3.5         | 13                                | 19 | 2.0     | 12.89   | 21.0 |

**Note: Products in this catalogue are subject to availability**



**Head Office: Concept Fasteners VIC**  
 9 Flight Drive, Tullamarine 3043, Victoria  
 Tel: (03) 9338 6633 Fax: (03) 9338 6433  
 : sales@conceptfasteners.com.au

**Head Office: Concept Fasteners NSW**  
 5 Liverpool St, Ingleburn 2565, NSW  
 Tel: (02) 9774 4416  
 : salesnsw@conceptfasteners.com.au

**Head Office: Concept Fasteners QLD**  
 Brisbane Branch Coming Soon!  
 : qldsales@conceptfasteners.com.au

## Stainless Steel large Flange - Semi-Hex Shank - Open Type

**Description****Large Flange HEX - Stainless Steel**

Ideal for applications that require an open nut insert and an almost flush head finished with high torque-to-turn ratio.

**Specifications**

|                     |                 |
|---------------------|-----------------|
| <b>Material</b>     | Stainless Steel |
| <b>Finish Clear</b> | Natural         |

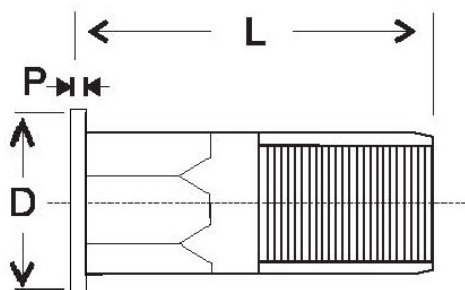

| PART NUMBER     | THREAD SIZE | GRIP RANGE (mm) | HEX HOLE SIZE<br>+0.10 -0.10 | A/F  | D  | L (UNDER HEAD) | P   |
|-----------------|-------------|-----------------|------------------------------|------|----|----------------|-----|
| INSERTEX M4LFSS | M4 x 0.7    | 0.5-2.5         | 6.1                          | 6.0  | 9  | 11.0           | 1   |
| INSERTEX M5LFSS | M5x0.8      | 0.5-3.0         | 7.1                          | 7.0  | 10 | 12.0           | 1   |
| INSERTEX M6LFSS | M6x1.0      | 0.5-3.0         | 9.1                          | 9.0  | 13 | 14.0           | 1.5 |
| INSERTEX M8LFSS | M8x1.25     | 0.5-3.0         | 11.1                         | 11.0 | 16 | 16.0           | 1.5 |
| INSERTEX        | 10x1.5      | 1.0-3.5         | 13.1                         | 13.0 | 19 | 19.0           | 2   |

**Note: Products in this catalogue are subject to availability**



**Head Office: Concept Fasteners VIC**  
 9 Flight Drive, Tullamarine 3043, Victoria  
 Tel: (03) 9338 6633 Fax: (03) 9338 6433  
 : sales@conceptfasteners.com.au

**Head Office: Concept Fasteners NSW**  
 5 Liverpool St, Ingleburn 2565, NSW  
 Tel: (02) 9774 4416  
 : salesnsw@conceptfasteners.com.au

**Head Office: Concept Fasteners QLD**  
 Brisbane Branch Coming Soon!  
 : qldsales@conceptfasteners.com.au

## Open End Steel zinc Full Hex High Torque Rivet Nuts

**Large Flange "FULL HEX" Rivet Nuts "High Torque"**

For applications where fastener removal post installation is problematic and where high push out resistance is needed.

HighTorque to turn resistance.

**Description****Thin Sheet Nut-Insert**

|                       |                          |
|-----------------------|--------------------------|
| <b>Specifications</b> | Full Hex Flat Head Type: |
| <b>Material</b>       | Low Carbon Steel         |
| <b>Finish</b>         | Zinc                     |

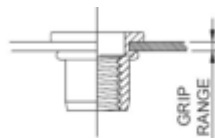
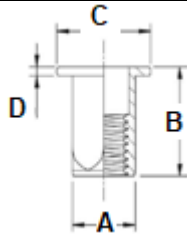

| Part Code           | Thread Size | Grip Range | Hole Size +0.1 | A -0.20 | B ± 0.35 | L ± 0.35 | P ± 0.2 | SE MIN |
|---------------------|-------------|------------|----------------|---------|----------|----------|---------|--------|
| INSERTEX M4FHLF     | M4 x 0.7    | 0.5 - 2.5  | 6.1            | 6       | 9        | 11.2     | 0.8     | 6.8    |
| INSERTEX M4FHLF-4   | M4 x 0.7    | 2.5 - 4.0  | 6.1            | 6       | 9        | 12.7     | 0.8     | 6.8    |
| INSERTEX M5FHLF     | M5 x 0.8    | 0.50 - 3.0 | 7.1            | 7       | 10       | 13       | 1       | 8      |
| INSERTEX M5FHLF4.5  | M5 x 0.8    | 3.0 - 4.5  | 7.1            | 7       | 10       | 14.5     | 1       | 8      |
| INSERTEX M6FHLF     | M6 x 1.0    | 0.5 - 3.0  | 9.1            | 9       | 13       | 16       | 1.5     | 10.3   |
| INSERTEX M6FHLF-5   | M6 x 1.0    | 3.0 - 5.0  | 9.1            | 9       | 13       | 18       | 1.5     | 10.35  |
| INSERTEX M8FHLF     | M8 x 1.25   | 0.5 - 3.0  | 11.1           | 11      | 16       | 18       | 1.5     | 12.6   |
| INSERTEX M8FHLF-5.5 | M8 x 1.25   | 3.0 - 5.5  | 11.1           | 11      | 16       | 20.5     | 1.5     | 12.65  |
| INSERTEX M10FHLF    | M10 x 1.50  | 1.0 - 4.5  | 13.1           | 13      | 19       | 24       | 2       | 14.9   |
| INSERTEX M10FHLF-6  | M10 x 1.50  | 4.0 - 6.0  | 13.1           | 13      | 19       | 25.5     | 2       | 14.95  |
| INSERTEX M12FHLF    | M12 x 1.75  | 1.5 - 5.0  | 16.1           | 16      | 23       | 27       | 2       | 18.3   |

| Thread Size | Pull-Out KN | Push-Out KN | Torque-To_turn Nm | Maximum Torque |
|-------------|-------------|-------------|-------------------|----------------|
| M4          | 6.8         | 2.6         |                   | 3.9            |
| M5          | 10.7        | 4.02        |                   | 7.8            |
| M6          | 14.71       | 5           |                   | 11.6           |
| M8          | 20.5        | 6.6         |                   | 26.5           |
| M10         | 33.3        | 10.2        |                   | 41.2           |
| M12         | 45.1        | 14.25       |                   | 56.7           |

Value higher than stated due to bolt breakage, figure provided for guidance.

All figure are indicative and subject to change without notice. Testing should be carried out for each application

**Note: Products in this catalogue are subject to availability**

## Open End Steel Zinc AH Type - Semi Hex Shank "High Torque to Turn"

**Description****Large Flange Semi-Hex AVK AH Series - Steel**

Ideal for applications that require an open nut insert where High pushout resistance is needed.

**Specifications**

|                 |             |
|-----------------|-------------|
| <b>Material</b> | Steel       |
| <b>Finish</b>   | Zinc plated |

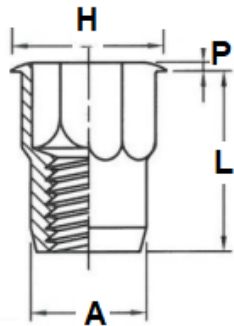

| Part Code             | Thread size | Grip Range | Hex hole | Flange H Diameter<br>+/-0.35 | L     | A     | P   |
|-----------------------|-------------|------------|----------|------------------------------|-------|-------|-----|
| INSERTEX M4AVK-AH     | M4 x 0.7    | 0.5-2.5    | 6.35     | 9.5                          | 9.8   | 6.2   | 0.7 |
| INSERTEX M4AVK-AH3.3  | M4 x 0.7    | 2.0-3.3    | 6.35     | 9.5                          | 11    | 6.2   | 0.7 |
| INSERTEX M5AVK-AH     | M5 x 0.8    | 0.5-3.3    | 7.15     | 9.9                          | 11.1  | 7     | 0.9 |
| INSERTEX M5AVK-AH7.9  | M5 x 0.8    | 3.3-5.7    | 7.15     | 9.9                          | 13.6  | 7     | 0.9 |
| INSERTEX M6AVK-AH     | M6 x 1.0    | 0.7-4.2    | 9.5      | 12.95                        | 14.8  | 9.35  | 0.9 |
| INSERTEX M6AVK-AH6.6  | M6 x 1.0    | 4.2-6.6    | 9.5      | 12.95                        | 17.4  | 9.35  | 0.9 |
| INSERTEX M8AVK-AH     | M8 x 1.25   | 0.7-3.8    | 12.7     | 16.65                        | 17.4  | 12.55 | 1   |
| INSERTEX M8AVK-AH7.9  | M8 x 1.25   | 3.8-7.9    | 12.7     | 16.65                        | 21.46 | 12.55 | 1   |
| INSERTEX M10AVK-AH    | M10 x 1.5P  | 0.7-3.8    | 12.7     | 16.65                        | 17.4  | 12.55 | 1   |
| INSERTEX M10AVK-AH7.9 | M10 x 1.5P  | 3.8-7.9    | 12.7     | 16.65                        | 21.46 | 12.55 | 1   |

| Thread Size | Pull-Out<br>KN | Push-Out<br>KN | Torque-To-Turn<br>Nm |
|-------------|----------------|----------------|----------------------|
| M4 x 0.7    | 9.8            | 1.47           | 4.9                  |
| M5 x 0.8    | 15.6           | 1.47           | 8.8                  |
| M6 x 1.0    | 20.6           | 2.45           | 15.7                 |
| M8 x 1.25   | 29.4           | 2.45           | 29.4                 |
| M10 X 1.50  | 42.1           | 3.92           | 39.2                 |

Value higher than stated due to bolt breakage, figure provided for guidance.

All figure are indicative and subject to change without notice. Testing should be carried out for each application

**Note: Products in this catalogue are subject to availability**



**Head Office: Concept Fasteners VIC**  
9 Flight Drive, Tullamarine 3043, Victoria  
Tel: (03) 9338 6633 Fax: (03) 9338 6433  
: sales@conceptfasteners.com.au

**Head Office: Concept Fasteners NSW**  
5 Liverpool St, Ingleburn 2565, NSW  
Tel: (02) 9774 4416  
: salesnsw@conceptfasteners.com.au

**Head Office: Concept Fasteners QLD**  
Brisbane Branch Coming Soon!  
: qldsales@conceptfasteners.com.au