

123 Fasteners - Thin Sheet Rivet Nuts

Closed End Steel Reduced Head - Countersunk

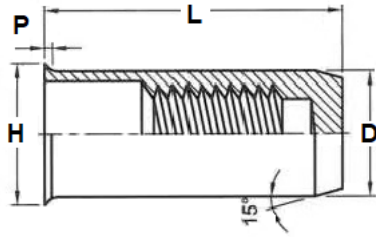

Part Number	Thread Size	Grip Range	Hole Size + -0.1	D +0.03/ -0.03	L +0.25	H +0.25	P
INSERNUT M4CE	M4 x 0.7	0.5 - 2.0	6.4	6.35	15	7.2	0.64
INSERNUT M5CE	M5 x 0.8	0.5 - 3.0	7.15	7.1	20.2	8.1	0.64
INSERNUT M6CE	M6 x 1.0	0.7 - 3.0	9.55	9.5	23.5	10.5	0.77
INSERNUT M8CE	M8 x 1.25	0.7 - 3.5	10.55	10.5	23	11.5	0.77

Thread Size	Pull-Out KN	Push-Out KN	Torque-To-Turn Nm	Maximum Torque
M4 x 0.7	6.1	1.5	2.1	5.2
M5 x 0.8	8.0	1.9	2.5	7.8
M6 x 1.0	11.4	2.5	3.3	12.7
M8 x 1.25	15.8	2.8	3.6	16.7

Closed End Stainless Steel Reduced Head A2 - Countersunk Round

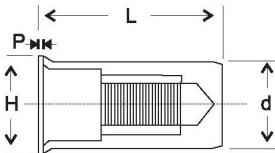

Part Number	Thread Size	L +0.5	D +0	H +0.25	P +0.03	Grip Range	Hole Size
INSERNUT M4CESS	M4 x 0.7	16.0	5.95	7.0	0.5	0.5 - 2.5	6.1
INSERNUT M5CESS	M5 x 0.8	18.0	6.95	8.0	0.5	0.5 - 3.0	7.1
INSERNUT M6CESS	M6 x 1.0	21.0	8.95	10.0	0.5	0.5 - 3.0	9.1
INSERNUT M8CESS	M8 x 1.25	23.5	10.95	12.0	0.5	0.5 - 3.0	11.1
INSERNUT M10CESS	M10 x 1.50	26.5	12.95	14.5	0.8	1.0 - 3.5	13.1

Note: Products in this catalogue are subject to availability



Head Office: Concept Fasteners VIC
 9 Flight Drive, Tullamarine 3043, Victoria
 Tel: (03) 9338 6633 Fax: (03) 9338 6433
 : sales@conceptfasteners.com.au

Concept Fasteners NSW
 5 Liverpool St, Ingleburn 2565, NSW
 Tel: (02) 9774 4416
 : salesnsw@conceptfasteners.com.au

Concept Fasteners QLD
 Brisbane Branch Coming Soon!

: qldsales@conceptfasteners.com.au

Closed End FULL HEX Steel Reduced Head "HIGH TORQUE"

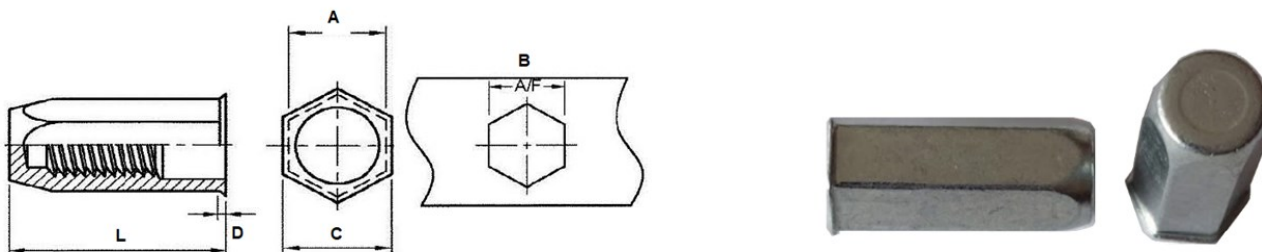

Dimensions

Part Code	Thread Size	Grip Range	A +0.1	B Hex Hole + 0.25	C +0.05/-0.15	D ± 0.1	L + 0.25
INSERTEX M4FHCE	M4 x 0.7	0.5 - 2.0	6	6.1	6.9	0.5	16
INSERTEX M5FHCE	M5 x 0.8	0.5 - 3.0	7	7.1	8	0.5	20
INSERTEX M6FHCE	M6 x 1.0	0.5 - 3.0	9	9.1	10	0.6	22
INSERTEX M6FHCE5.5	M6 x 1.0	3.0 - 5.5	9	9.1	10	0.6	24
INSERTEX M8FHCE	M8 X 1.25	0.7 - 3.0	11	11.01	12	0.6	25.5

Closed End Steel Large Flange A2 Stainless Steel

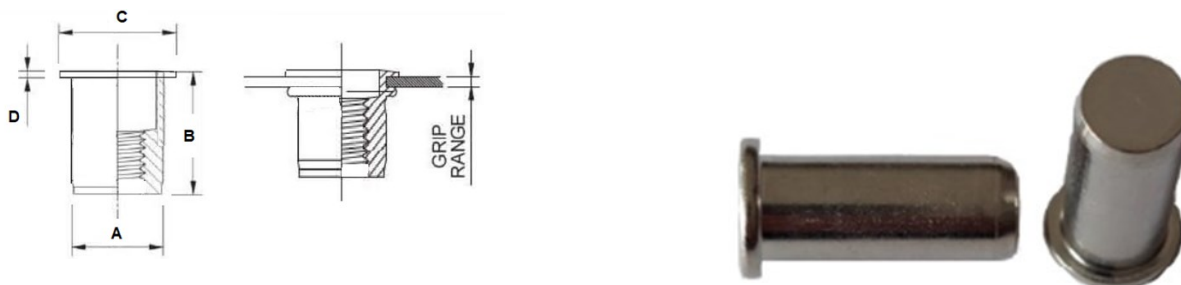

Dimensions

Part Code	Thread Size	Grip Range	Hole Size +0.1	A +0.05/-0.15	B ± 0.25	C ± 0.25	D ± 0.05/-0.15
INSERTNUT M4LFCES	M4 x 0.7	0.5 - 2.5	6.1	5.95	16	9	1
INSERTNUT M5LFCES	M5 x 0.8	0.5 - 3.0	7	6.95	18	10	1
INSERTNUT M5LFCES7.5	M5 x 0.8	6.0 - 7.5	7	6.95	22.5	10	1
INSERTNUT M6LFCES	M6 x 1.0	0.5 - 3.0	9.1	8.95	22.5	11.8	1.5
INSERTNUT M8LFCES	M8 x 1.25	0.9 - 3.0	11.1	10.95	23.5	15	1.5
INSERTNUT M10LFCES	M10 x 1.50	1.0 - 3.5	13.1	12.95	26.5	17	2.5

Thread Size	Pull-Out KN	Push-Out KN	Torque-To_turn Nm
M4 x 0.7	9.8	4.9	4.9
M5 x 0.8	15.6	6.86	8.8
M6 x 1.0	20.6	2.94	15.7
M8 x 1.25	29.4	12.74	29.4
M10 x 1.50	42.1	15.68	39.2

Note: Products in this catalogue are subject to availability



Head Office: Concept Fasteners VIC
9 Flight Drive, Tullamarine 3043, Victoria
Tel: (03) 9338 6633 Fax: (03) 9338 6433
: sales@conceptfasteners.com.au

Head Office: Concept Fasteners NSW
5 Liverpool St, Ingleburn 2565, NSW
Tel: (02) 9774 4416
: salesnsw@conceptfasteners.com.au

Head Office: Concept Fasteners QLD
Brisbane Branch Coming Soon!

: qldsales@conceptfasteners.com.au