

## Lifting Eye Bolts 9100

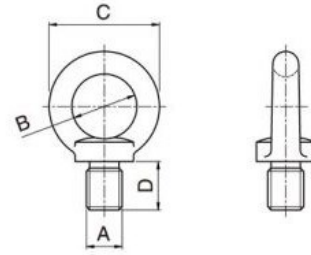

Name	Material	Surfaced Process
Base Structure	Steel (ST)	Yellow ZP (YC)

Part Code	A	B	C	D	Loading KG
9100-M6	M6	20	33	15	80
9100-M8	M8	20	33	15	80
9100-M10	M10	25	44	18	150
9100-M12	M12	30	50	22	220
9100-M14	M14	35	60	27	300
9100-M16	M16	35	60	27	450
9100-M18	M18	40	72	30	630
9100-M20	M20	40	72	30	630
9100-M22	M22	50	90	35	950
9100-M24	M24	50	90	38	950
9100-M27	M27	60	110	48	1500
9100-M30	M30	60	110	48	1500
9100-M33	M33	70	133	55	2300
9100-M36	M36	70	133	55	2300
9100-M42	M42	80	151	65	3400
9100-M48	M48	80	151	65	4500
9100-M64	M64	110	210	90	9000

## ST. Lifting Eye Bolts 9101

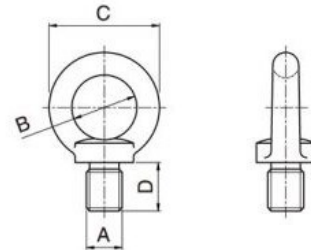

Name	Material
Base Structure	Stainless Steel (SST)

Part Code	A	B	C	D	Loading KG
9101-M6	M6	20	33	15	80
9101-M8	M8	20	33	15	80
9101-M10	M10	25	41	18	150
9101-M12	M12	30	50	22	220
9101-M14	M14	35	60	27	300
9101-M16	M16	35	60	27	450
9101-M18	M18	40	72	30	630
9101-M20	M20	40	72	30	630
9101-M22	M22	50	90	35	950
9101-M24	M24	50	90	39	950

**Note: Products in this catalogue are subject to availability**