

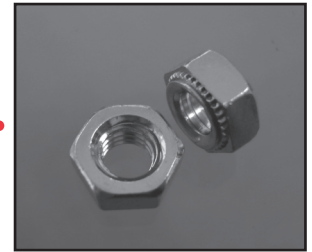

Self-Clinching KAL Hex Nuts

Series CKN



CKN self-clinching KAL-nuts provide strong internal threads in sheet material as thin as 1 mm.

Series	Material	Finish
CKN	Heat-treated Carbon Steel	Zinc* Clear

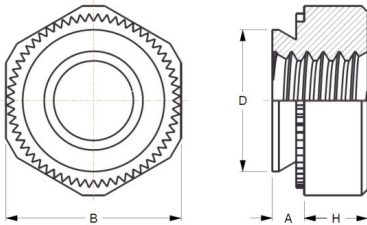

*See Finish Spec. on Page 6.

Thread: Internal 6H, ANSI/ASME B1.13.

Use in: CKN – Materials with Rockwell Hardness of HRB-80 or less.

Dimensions & Specifications

Thread Size	Part Number Carbon Steel	D Max	B +0.00 -0.20	H ±0.10	A Max.			
						Min.	+0.08 -0.00	Min.
M3 x 0.5	CKNM3-1	4.45	5.5	2.0	1.0	1.0	4.5	4.5
	CKNM3-2				1.4	1.4		
M4 x 0.7	CKNM4-1	5.45	7.0	2.2	1.0	1.0	5.5	5.5
	CKNM4-2				1.4	1.4		
M5 x 0.8	CKNM5-1	6.45	8.0	3.0	1.0	1.0	6.5	6.5
	CKNM5-2				1.4	1.4		
M6 x 1.0	CKNM6-1	7.95	10.0	4.0	1.0	1.0	8.0	8.0
	CKNM6-2				1.4	1.4		
M8 x 1.25	CKNM8-2	9.95	13.0	4.5	1.4	1.4	10.0	10.0
	CKNM8-3				2.0	2.0		

Installation & Performance Data

Thread Size	Shank	Min. Sheet	Cold-rolled Steel			5052-H34 Aluminum		
			Installation Force (kN)	Pushout (N)	Torque-out (N•m)	Installation Force (kN)	Pushout (N)	Torque-out (N•m)
M3 x 0.5	-1	1.0	11.7	490	1.96	5.8	290	1.17
	-2	1.4	12.7	780	2.45	6.8	580	1.47
M4 x 0.7	-1	1.0	12.7	580	2.94	7.8	390	1.96
	-2	1.4	13.7	880	3.92	9.8	680	2.94
M5 x 0.8	-1	1.0	13.7	680	3.92	8.8	440	2.94
	-2	1.4	14.7	980	4.9	10.7	730	3.92
M6 x 1.0	-1	1.0	16.6	880	7.84	11.7	580	5.88
	-2	1.4	19.6	1270	11.76	13.7	880	7.84
M8 x 1.25	-2	1.4	24.5	1370	15.69	15.6	1070	9.80
	-3	2.0	29.4	1760	19.61	17.6	1370	11.76