

Lock Nuts

**Part Number**

Nuts0251-1

Nuts0250-1

Product Description

M6 Clutch Nut Plated Zinc Black Flake

M8 Clutch Nut Plated Zinc Black Flake

Material

Mild Steel DIN 980

Mild Steel DIN 980

Note: Other sizes available upon request

Keeps Nuts

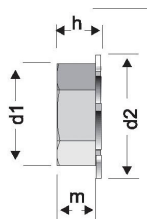
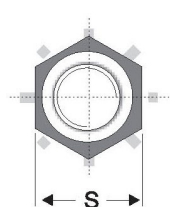

Part Number	P	m	S	h	d2
KEPS M3	0.5	2.4	5.5	3.1	6.3
KEPS M4	0.7	3.2	7	4.0	7.0
KEPS M5	0.8	4.0	8	5.1	9.2
KEPS M6	1.0	5.0	10	6.1	11.0
KEPS M8	1.25	6.5	13	7.9	14.9
KEPS M10	1.5	8.0	17	9.6	19.0

Wizz Lock Nuts - DIN 6923

Part Number	Description
CFZ-M3WLN	M3 Steel Zinc
CFZ-M4WLN	M4 Steel Zinc
CFZ-M5WLN	M5 Steel Zinc
CFZ-M6WLN	M6 Steel Zinc
CFZ-M8WLN	M8 Steel Zinc
CFZ-M10WLN	M10 Steel Zinc
CFZ-M12WLN	M12 Steel Zinc
CFZ-M16WLN	M16 Steel Zinc



Note: Products in this catalogue are subject to availability



Head Office: Concept Fasteners VIC
 9 Flight Drive, Tullamarine 3043, Victoria
 Tel: (03) 9338 6633 Fax: (03) 9338 6433
 : sales@conceptfasteners.com.au

Head Office: Concept Fasteners NSW
 5 Liverpool St, Ingleburn 2565, NSW
 Tel: (02) 9774 4416
 : salesnsw@conceptfasteners.com.au

Head Office: Concept Fasteners QLD
 Brisbane Branch Coming Soon!
 : qldsales@conceptfasteners.com.au