

Cast Iron Weld On Drop-side Hinges

Cast Iron Weld on Hinge

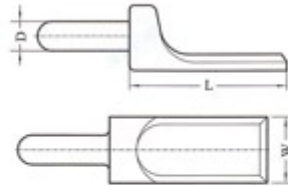

* Material: Steel
* Surface treatment: Raw

编号 Item No.	01150	01151	01152	01153
L	115	83	80	75
W	40	35	30	25
D	20	16	14	12
(kg) Weight	0.616	0.381	0.258	0.178

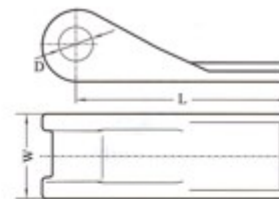

* Material: Steel
* Surface treatment: Raw

Item No.	01154	01155	01156	01157
L	105	103	88	80
W	50	40	34	25
D	20.5	16.5	14.5	12.5
(kg) Weight	0.598	0.475	0.28	0.166

Concept Fasteners Pty Ltd

Part Number example

01151/01155

Product Description

Cast Iron Weld on Hinge D=16.5mm L=103mm W=40mm

Steel

Cast Iron Weld on Gudgeon D=16mm L=83mm W=35mm

Steel

Note: Products in this catalogue are subject to availability