

Tapered Dowel Pins to DIN 7979

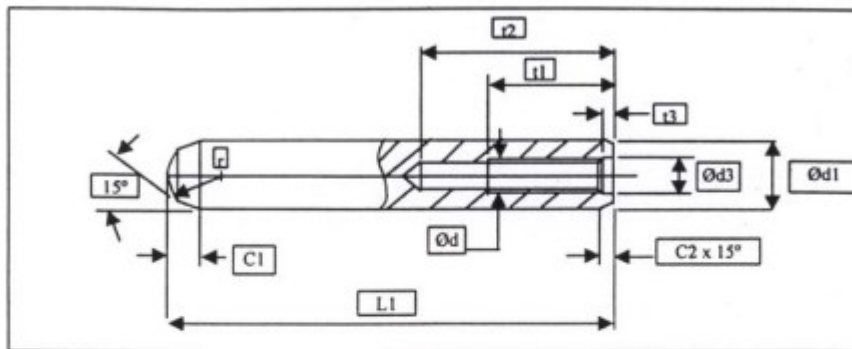

**Concept Precision Drill Jig Bushings**

**Dowel Pins – Case Hardened & Tapped to DIN 7979**



Ød1m6	6	8	10	12	14	16	18	20
Ød2	M4	M5	M6	M6	M8	M8	M10	M10
Ød3	4.3	5.3	6.3	6.3	8.3	8.3	10.3	10.3
t1	6	8	10	12	12	16	20	20
t2	10	13	16	18	18	23	27	27
t3	1	1.2	1.2	1.2	1.2	1.6	1.6	1.6
C1	2.1	2.6	3	3.8	3.8	4	4.7	6
C2	0.8	1	1.2	1.6	1.8	1.8	2	2.5
r	6	10	10	14	16	16	20	20

L1	Tolerance	L1	Tolerance
16	+0.35 / -0.35	50	+0.50 / -0.50
18	+0.35 / -0.35	55	+0.60 / -0.60
20	+0.42 / -0.42	60	+0.60 / -0.60
24	+0.42 / -0.42	70	+0.60 / -0.60
28	+0.42 / -0.42	80	+0.60 / -0.60
32	+0.50 / -0.50	90	+0.70 / -0.70
36	+0.50 / -0.50	100	+0.70 / -0.70
40	+0.50 / -0.50	120	+0.70 / -0.70
45	+0.50 / -0.50		

All dimensions in millimetres

*Note: Products in this catalogue are subject to availability*



Head Office: Concept Fasteners VIC  
 9 Flight Drive, Tullamarine 3043, Victoria  
 Tel: (03) 9338 6633 Fax: (03) 9338 6433  
 : sales@conceptfasteners.com.au

Head Office: Concept Fasteners NSW  
 5 Liverpool St, Ingleburn 2565, NSW  
 Tel: (02) 9774 4416  
 : salesnsw@conceptfasteners.com.au

Head Office: Concept Fasteners QLD  
 Brisbane Branch Coming Soon!  
 : qldsales@conceptfasteners.com.au