

Hand Rivet Nut Tool BT603

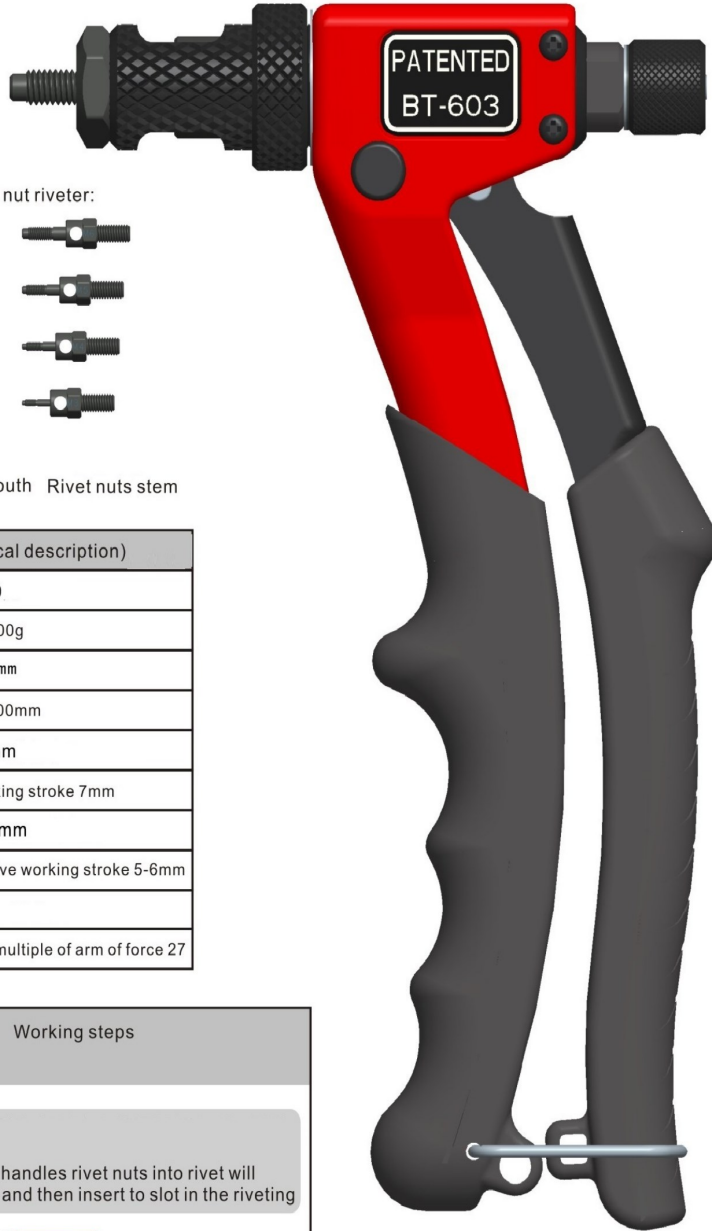

Parts of Hand nut riveter:

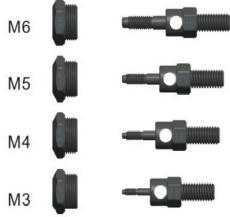

Nut guide mouth Rivet nuts stem

(Technical description)	
▶ 1.	500
	Weight 500g
▶ 2.	200mm
	Length 200mm
▶ 3.	7mm
	Max working stroke 7mm
▶ 4.	5-6mm
	Max effective working stroke 5-6mm
▶ 5.	27
	The largest multiple of arm of force 27

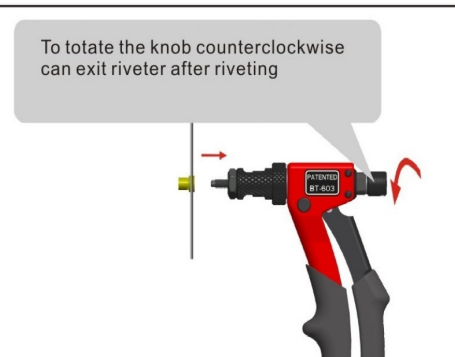
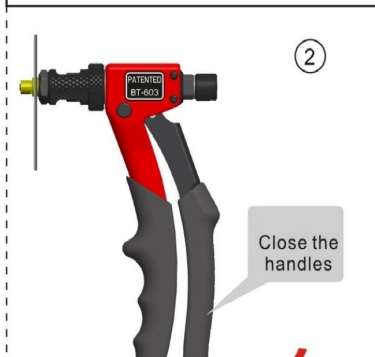
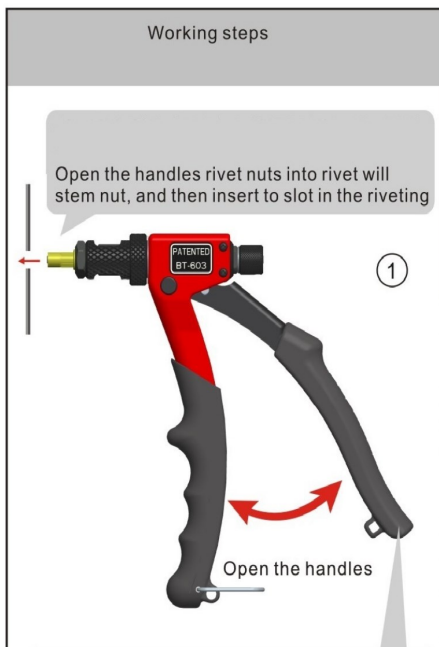

Replacing steps

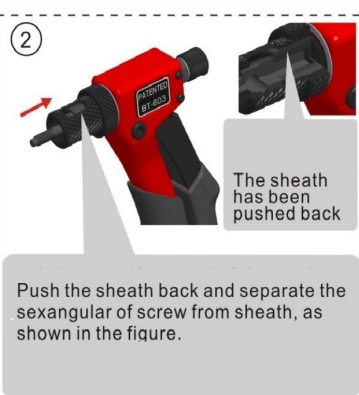

Note: Products in this catalogue are subject to availability



Head Office: Concept Fasteners VIC
 9 Flight Drive, Tullamarine 3043, Victoria
 Tel: (03) 9338 6633 Fax: (03) 9338 6433
 : sales@conceptfasteners.com.au

Concept Fasteners NSW
 5 Liverpool St, Ingleburn 2565, NSW
 Tel: (02) 9774 4416
 : salesnsw@conceptfasteners.com.au

Concept Fasteners QLD
 Brisbane Branch Coming Soon!
 : qldsales@conceptfasteners.com.au