

Open End Steel zinc Full Hex High Torque Rivet Nuts

Large Flange "FULL HEX" Rivet Nuts "High Torque"

For applications where fastener removal post installation is problematic and where high push out resistance is needed.

HighTorque to turn resistance.

Description**Thin Sheet Nut-Insert**

Specifications	Full Hex Flat Head Type:
Material	Low Carbon Steel
Finish	Zinc

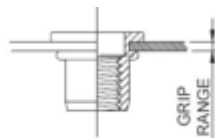
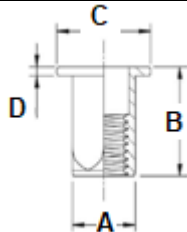

Part Code	Thread Size	Grip Range	Hole Size +0.1	A -0.20	B ± 0.35	L ± 0.35	P ± 0.2	SE MIN
INSERTEX M4FHLF	M4 x 0.7	0.5 - 2.5	6.1	6	9	11.2	0.8	6.8
INSERTEX M4FHLF-4	M4 x 0.7	2.5 - 4.0	6.1	6	9	12.7	0.8	6.8
INSERTEX M5FHLF	M5 x 0.8	0.50 - 3.0	7.1	7	10	13	1	8
INSERTEX M5FHLF4.5	M5 x 0.8	3.0 - 4.5	7.1	7	10	14.5	1	8
INSERTEX M6FHLF	M6 x 1.0	0.5 - 3.0	9.1	9	13	16	1.5	10.3
INSERTEX M6FHLF-5	M6 x 1.0	3.0 - 5.0	9.1	9	13	18	1.5	10.35
INSERTEX M8FHLF	M8 x 1.25	0.5 - 3.0	11.1	11	16	18	1.5	12.6
INSERTEX M8FHLF-5.5	M8 x 1.25	3.0 - 5.5	11.1	11	16	20.5	1.5	12.65
INSERTEX M10FHLF	M10 x 1.50	1.0 - 4.5	13.1	13	19	24	2	14.9
INSERTEX M10FHLF-6	M10 x 1.50	4.0 - 6.0	13.1	13	19	25.5	2	14.95
INSERTEX M12FHLF	M12 x 1.75	1.5 - 5.0	16.1	16	23	27	2	18.3

Thread Size	Pull-Out KN	Push-Out KN	Torque-To_turn Nm	Maximum Torque
M4	6.8	2.6		3.9
M5	10.7	4.02		7.8
M6	14.71	5		11.6
M8	20.5	6.6		26.5
M10	33.3	10.2		41.2
M12	45.1	14.25		56.7

Value higher than stated due to bolt breakage, figure provided for guidance.

All figure are indicative and subject to change without notice. Testing should be carried out for each application

Note: Products in this catalogue are subject to availability