

Open End Stainless Steel Large Flange - Splined

Description

Large Flange splined - Stainless Steel

Highest resistance to vibration and spin-out of all round bodied inserts, flange with near flush finish, very wide grip range.

Specifications

Material Stainless steel
Finish Clear Natural

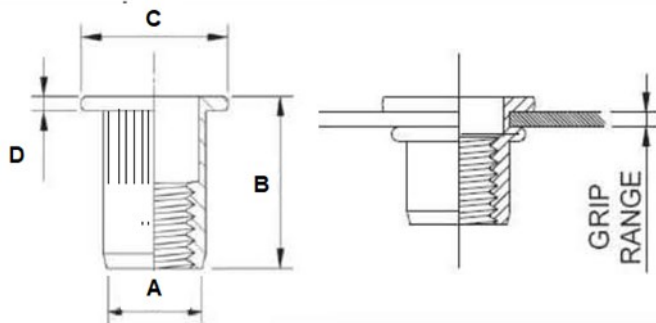

Dimensions

Part Code	Thread Size	Grip Range	Hole Size +0.1	A +0.05/-0.15	B ± 0.25	C ± 0.25	D ± 0.25
INSERNUT M3LFSPSS	M3 x 0.5	0.3 - 2.0	5	4.85	9	8	0.9
INSERNUT M4LFSPSS	M4 x 0.7	0.3 - 2.5	6	5.85	11	9	1
INSERNUT M4LFSPSS4.0	M4 x 0.7	2.5 - 4.0	6	5.85	12.5	9	1
INSERNUT M5LFSPSS	M5 x 0.8	0.3 - 3.0	7	6.85	12	10	1
INSERNUT M5LFSPSS4.5	M5 x 0.8	3.0 - 4.5	7	6.85	13.5	10	1
INSERNUT M6LFSPSS	M6 x 1.0	0.5 - 3.0	9	8.85	14	13	1.5
INSERNUT M6LFSPSS5.0	M6 x 1.0	3.0 - 5.0	9	8.85	16	13	1.5
INSERNUT M8LFSPSS	M8 x 1.25	0.5 - 3.0	11	10.85	16	16	1.5
INSERNUT M8LFSPSS5.5	M8 x 1.25	3.0 - 5.5	11	10.85	18.5	16	1.5
INSERNUT M10LFSPSS	M10 x 1.50	1.0 - 3.5	13	12.85	19	17	2
INSERNUT M10LFSPSS6.0	M10 x 1.50	3.5 - 6.0	13	12.85	21.5	17	2
INSERNUT M12LFSPSS	M12 x 1.75	1.0 - 4.0	16	15.8	23.2	22	2

Thread Size	Pull-Out KN	Push-Out KN	Torque- To_turn
M4 x 0.7	9.806	4.903	4.906
M5 x 0.8	15.69	6.864	8.826
M6 x 1.0	20.593	9.806	15.691
M8 x 1.25	42.168	12.748	N/A
M10 x 1.50	42.168	12.748	N/A

Value higher than stated due to bolt breakage, figure provided for guidance.

All figure are indicative and subject to change without notice. Testing should be carried out for each application

Note: Products in this catalogue are subject to availability



Head Office: Concept Fasteners VIC
 9 Flight Drive, Tullamarine 3043, Victoria
 Tel: (03) 9338 6633 Fax: (03) 9338 6433
 : sales@conceptfasteners.com.au

Concept Fasteners NSW
 5 Liverpool St, Ingleburn 2565, NSW
 Tel: (02) 9774 4416
 : salesnsw@conceptfasteners.com.au

Concept Fasteners QLD
 Brisbane Branch Coming Soon!
 : qldsales@conceptfasteners.com.au